



University Of Technology
Building and Construction Eng. Dept.
End Exam –2012/2013



All branches
subject : Drawing Eng.
Examiner :Eng. Drawing Committee

Class: 1st Year
Time : 3 Hours
Date : 16-6-2013

Q1- See the views of figure below and conclude the third one, with draw isometric of it.(Choose only one). (40 marks)

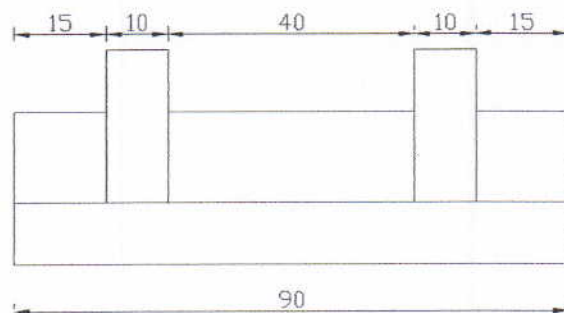
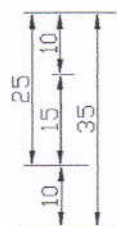
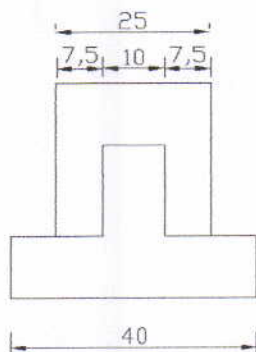
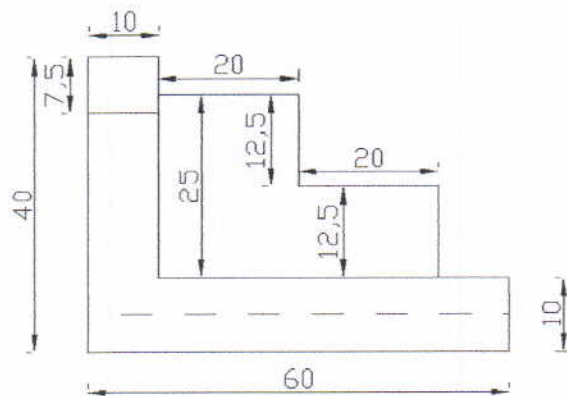
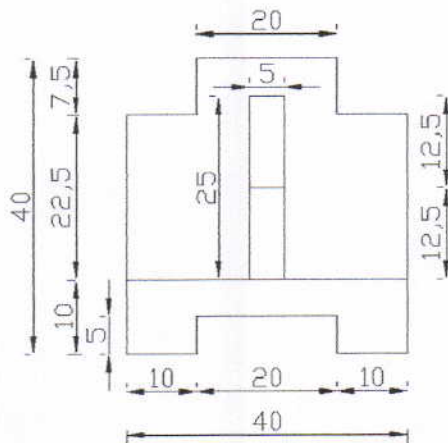



University Of Technology
Building and Construction Eng. Dept.
Answer of End Exam –2012/2013



All branches

subject : Drawing Eng.

Examiner :Eng. Drawing Committee

Class: 1st Year

Time : 3 Hours

Date : 16-6-2013

Q1-

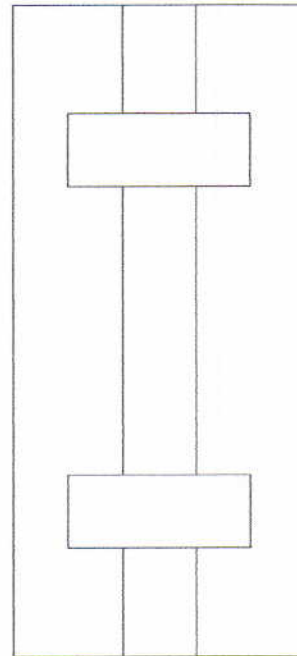
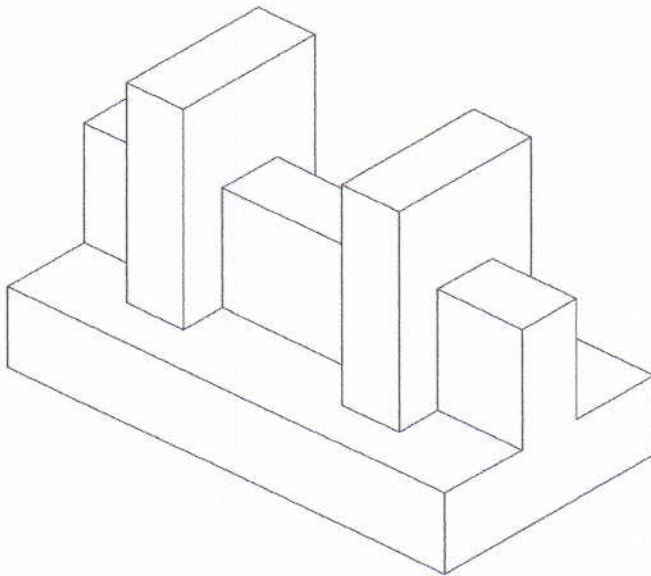
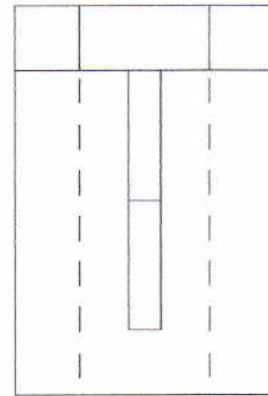
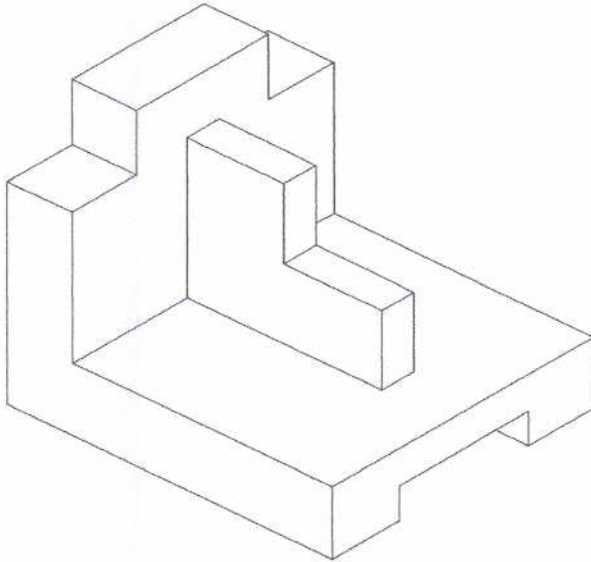

Q2-

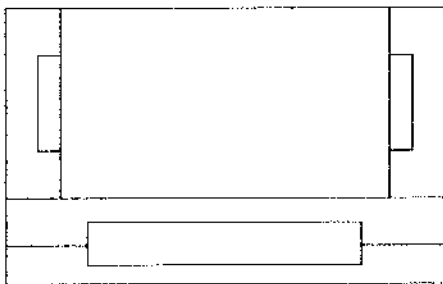
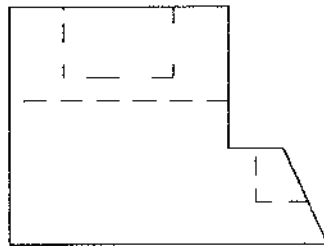
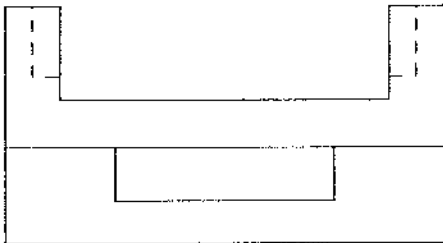
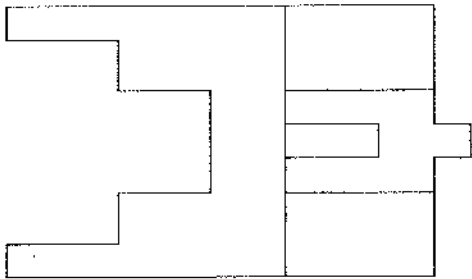
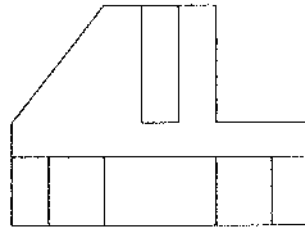
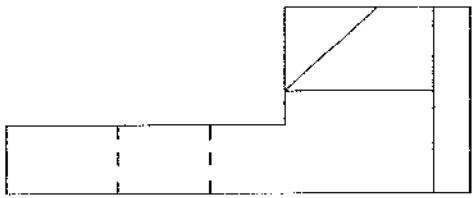

Q3-

